

✓  
CFD

FILED  
BY:           
2020 JUN -1 AM 8:46

VIOLETTA TINNELL  
SUPERIOR COURT CLERK

1 NANCY KNIGHT  
2 1803 E. Lipan Circle  
3 Fort Mohave, AZ 86426  
4 (928) 768-1537  
nancyknight@frontier.com

5 Plaintiff Pro Per

6 **IN THE SUPERIOR COURT OF THE STATE OF ARIZONA**  
7 **IN AND FOR THE COUNTY OF MOHAVE**

8 NANCY KNIGHT,  
9  
10 Plaintiff,

CASE NO.: CV 2018-04003

11 vs.

**MOTION FOR SUMMARY  
JUDGMENT TO FORGIVE SPECIFIC  
VIOLATIONS OF DESERT LAKES  
GOLF COURSE AND ESTATES'  
COVENANTS, CONDITIONS AND  
RESTRICTIONS**

12 GLEN LUDWIG AND PEARL LUDWIG,  
13 TRUSTEES OF THE LUDWIG FAMILY  
14 TRUST; FAIRWAY CONSTRUCTORS, INC.;  
MEHDI AZARMI; JAMES B. ROBERTS  
15 AND DONNA M. ROBERTS, HUSBAND  
AND WIFE; JOHN DOES 1-10; JANE DOES  
1-10; ABC CORPORATIONS 1-10; AND XYZ  
16 PARTNERSHIPS 1-10.

**(Assigned to Hon. Lee Jantzen)**

17 Defendants.

18 COMES NOW Nancy Knight, Plaintiff Pro Per, pursuant to 16 A.R.S. Rules of  
19 Civil Procedure, Rule 56 Summary Judgment. This request for summary judgment  
20 regarding forgiveness is strictly limited to conditions and restrictions (hereinafter  
21 “Servitudes”) 6 and 8 for Desert Lakes Golf Course and Estates Declarations of  
22 Covenants, Conditions and Restrictions (hereinafter “CC&Rs”). Forgiveness is requested  
23 for setback violations in Tract 4076-B that occurred prior to 2015 and due to no fault of  
24 the current or future property owner(s). Forgiveness for Servitude 8 for wrought iron  
25  
26  
27  
28

MOTION FOR SUMMARY JUDGMENT ON FORGIVENESS OF SPECIFIC CC&R VIOLATIONS - 1



1 fence color is requested for all alphabetically suffixed tracts for the fence color chosen by  
2 the developer of the lot and maintained as built. Plaintiff's signature is her affidavit.

3  
4 **STATEMENT OF FACTS**

5 Plaintiff has been adjudicated rights to prosecute violations in Tract 4076-B and  
6 her original Complaint had expected a Declaratory Judgment on forgiveness, Whereas F.  
7 Plaintiff recently learned, through an attorney consult, that the Superior Court can rule on  
8 law and fact in a Summary Judgment. This Summary Judgment is intended to  
9 uncomplicate a pending Amended Complaint or new Complaint.  
10

11 The Defendants, in Oral Arguments heard on May 11, 2020, resorted to using  
12 setback data among their arguments for dismissal of this case. This setback data carries a  
13 risk for Mohave County Development Services in issuing Board of Supervisor  
14 Resolutions and building permits in violation of an unknown number of Special  
15 Development/Residential zoning setbacks which were approved by the Board to be in  
16 conformance with the CC&R setbacks and was later approved as intended to be failsafe  
17 by CEO Frank Passantino of Desert Lakes Development L.P. with clarification in Res 93-  
18 122 for all lots to be twenty feet front and rear even for the subdivided lots in Plaintiff's  
19 Parcel VV. Adding the County as a Defendant will complicate the Complaint in the  
20 absence of some measure of forgiveness for current property owners who purchased lots  
21 with violations due to no fault of their own.  
22  
23  
24  
25

26 In oral arguments on May 11, the defendants also raised the issue of the Plaintiff's  
27 wrought iron fence color. This Summary Judgment is intended to prevent the additional  
28

1 defendants of T&M Development and possibly Mohave County for the County  
2 Assurance imposed upon T&M for the fence design and possibly the developer's choice  
3 of white as the wrought iron fence color.  
4

5 The reason for specificity of Tract 4076-B for setbacks is not only because of the  
6 Plaintiff's adjudicated rights to prosecute in this tract, that is still a matter of Court  
7 Reconsideration, but to conform with the specific language used in Servitude 6.  
8

9 The Court is in the process of evaluating all language differentiation in the  
10 Declarations that have specific meanings for calling out alphabetically suffixed tract  
11 names, such as Tract 4076-B, and the use of "said tract" that is not defined, and the use of  
12 the word "subdivision" that has specific meaning in law.  
13

14 A map of the boundary for the lots defined for Tract 4076-B in Servitude 6 is  
15 provided to show that Phase III was eliminated as a label on the approved 1988  
16 Preliminary Plat through the combining of Phase II and II for Tract 4076-B for all lots  
17 specified in the Tract 4076-B Declaration. **Exhibit 1**- Paving Plan map of the boundary  
18 for Tract 4076-B dated September 9, 1989 as provided by County Development Services  
19 to the Plaintiff on March 3, 2020. **Exhibit 2** – 2 pages from the Tract 4076-B Declaration  
20 for Servitudes 6 and 8.  
21

22 The total number of parcel numbers (hereinafter "APNs") for these affected lots is  
23 two hundred ninety (290) that have Assessor's Property Descriptions as Tract 4076-B,  
24 Tract 4076-D, Tract 4163, and Tract 4132. **Exhibit 3** – Excel Worksheet of APNs  
25 modified to fit seven pages.  
26  
27  
28

1 If the Court deems the owners of these parcel numbers are indispensable parties,  
2 the Plaintiff requests that she is only obligated to publish an advertisement in the Mohave  
3 Daily News or other publication distributed to the said subdivision Tract 4076 to run at  
4 least twice either as a legal notice or a display ad. The Plaintiff's choice of the ad style to  
5 be limited to a cost of \$300 or less.  
6

7 Plaintiff pleads for clarification and direction if any part of this request needs  
8 amendment for rules of order, procedure or other matter.  
9

10  
11 RESPECTFULLY SUBMITTED this 1st day of June, 2020.

12   
13 NANCY KNIGHT  
14 Plaintiff Pro Per  
15  
16  
17  
18  
19  
20  
21  
22  
23  
24  
25  
26  
27  
28

1  
2  
3  
4  
5  
6  
7  
8  
9  
10  
11  
12  
13  
14  
15  
16  
17  
18  
19  
20  
21  
22  
23  
24  
25  
26  
27  
28

**Exhibit 1**

Paving Plan map of the boundary for Tract 4076-B dated September 9, 1989 as provided by County Development Services to the Plaintiff on March 3, 2020.

2132-1

Tract 4076-B

**PAVING PLANS  
DESERT LAKES GOLF COURSE AND ESTATES  
TRACT 4076-B**  
SITUATED IN PORTIONS OF SECTIONS 35 AND 36.  
T. 19N., R. 22W., G. & S.R.B. & M.,  
MOHAVE COUNTY, ARIZONA



**INDEX**

- 1 COVER SHEET
- 2 DESERT LAKES DRIVE
- 3 DESERT LAKES PLACE
- 4 FAIRWAY DRIVE
- 5 FAIRWAY SINGLE FAIRWAY DRIVE
- 6 FAIRWAY COURT
- 7 FAIRWAY BLDG
- 8 MOUNTAIN VIEW ROAD
- 9 MOUNTAIN VIEW COURT
- 10 MOUNTAIN VIEW ROAD
- 11 DESERT GREENS DRIVE
- 12 DESERT GREENS LANDSCAPE DRIVE
- 13 DESERT GREENS DRIVE
- 14 DESERT GREENS DRIVE
- 15 DESERT GREENS DRIVE
- 16 DESERT GREENS DRIVE
- 17 DESERT GREENS DRIVE
- 18 DESERT GREENS DRIVE
- 19 DESERT GREENS DRIVE
- 20 DESERT GREENS DRIVE
- 21 DESERT GREENS DRIVE
- 22 DESERT GREENS DRIVE
- 23 DESERT GREENS DRIVE
- 24 DESERT GREENS DRIVE
- 25 DESERT GREENS DRIVE

**TYPICAL STREET SECTIONS**

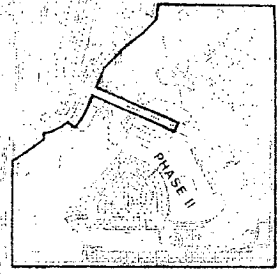
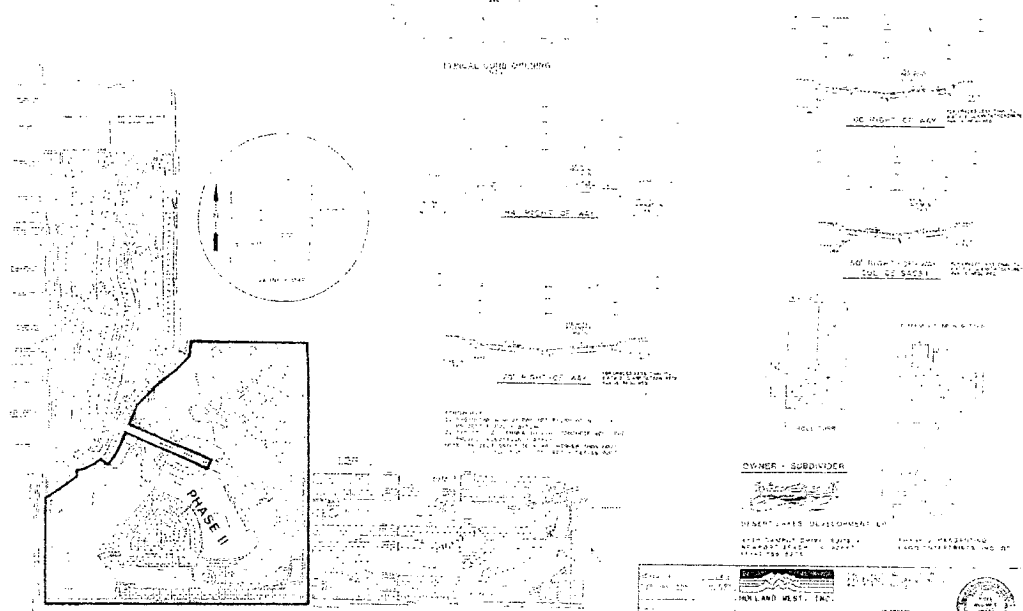

**OWNER - SUBDIVIDER**  
DESERT LAKES DEVELOPMENT, INC.  
10000 DESERT LAKES DRIVE, SUITE 100  
MESA, ARIZONA 85207

**DESIGNER**  
HOKI USA  
10000 DESERT LAKES DRIVE, SUITE 100  
MESA, ARIZONA 85207

**RECORDING OFFICE**  
MOHAVE COUNTY, ARIZONA

**COVER SHEET**  
2132-1

Sept 8, 1979

Phase II + Phase III

1  
2  
3  
4  
5  
6  
7  
8  
9  
10  
11  
12  
13  
14  
15  
16  
17  
18  
19  
20  
21  
22  
23  
24  
25  
26  
27  
28

**Exhibit 2**

2 pages from the Tract 4076-B Declaration for Servitudes 6 and 8.

Exhibit 2

2995

be completed within twelve (12) months from the commencement of construction. Mobile homes and all structures built, constructed or prefabricated off the premises are expressly prohibited, including but not limited to modular or manufactured structures and existing structures.

2. No noxious or offensive activities shall be carried on upon any lot, nor shall anything be done thereon which may be or may become an annoyance or nuisance to the neighborhood.

3. No lot shall be conveyed or subdivided smaller than that shown or delineated upon the original plat map, but nothing herein contained shall be so construed as to prevent the use of one lot and all or a fraction of an adjoining lot as one building site, after which time such whole lot and adjacent part of the other lot shall be considered as one lot for the purposes of these restrictions.

4. All buildings on lots not adjacent to the golf course being lots shall have a minimum of one thousand four hundred (1,400) square feet of living space, exclusive of garages, porches, patios and basements. Buildings on all other lots, being those lots adjacent to the golf course, in Tract 4076-B shall have a minimum of one thousand six hundred (1,600) square feet of living space, exclusive of garages, porches, patios and basements. No construction shed, basement, garage, tent, shack, travel trailer, recreational vehicle, camper or other temporary structure shall at any time be used as a residence.

5. All buildings shall have: (i) a maximum building height of Thirty (30) feet from the surface of the lot to the peak of the highest projection thereof; (ii) no more than two stories; (iii) no exposed radio, radio-telephone, television or microwave receiving or transmitting antennas, masts or dishes; (iv) no airconditioning unit on roofs; (v) a closed garage with interior dimensions of no less than twenty (20) feet; (vi) on any roof visible from ground level at any point within Tract 4076-B as its exposed visible surface, clay, concrete or ceramic tile, slate, or equal as may be approved by the Committee on Architecture; (vii) tempered glass in all windows facing fairways and driving range lakes.

6. All buildings and projections thereof on lots not adjacent to the golf course being Lots 31, 32, 33, 34, 35, 36, 37, 41, 42, 69, 74, 78, 79, 80, and 108 Block F, Lots 1, 2, 3, 4, 5, 6, 7, 8, 9, 10, 11, 12, 13, 14, 15, 16, 17, 18, 19, 20, 21, and 22 Block G, Lots 21, 22, 26, 27, 28, 29, 30, 33, 34, 35, 36, 37, 38, 66, 67, and 68 Block H, Lots 1, 2, 3, 4, 5, 6, 7, 8, 9, 10, 11, 12, 13, 14, 15, 16, 17, 18, 19, 20, 21, 22, 23, and 24 Block I, Lots 1, 2, 3, 4, 5, 6, 7, 8, 9, 10, 11, 12, 13, 14, 15, 16, and 17 Block J, and Lots 1, 2, 3, 4, 5, 6, and 7 Block K shall be constructed not less than twenty feet (20') back from the front and rear property lines and five feet (5') from side property lines. All buildings and projections thereof on all other lots of Tract 4076-B, being those lots adjacent to the golf course shall be constructed not less than twenty feet (20') from the front and rear property lines and five feet (5') from the side property lines.

7. Lots 75 through 86 inclusive, Block F, shall not have direct vehicular driveway access to Mountain View Road or Lippan Boulevard, as the case may be, but rather shall have vehicular access from the twenty-four foot (24') access easement as depicted on the plat. No automobiles, motorcycles, bicycles or other vehicles shall be parked in said access easement.

8. Fences and walls shall not exceed six (6) feet in height and shall not be constructed in the street set back area (being twenty feet (20') from the front property line). Fences and



walls visible from the street must be decorative and shall not be of wire, chain link, or wood or topped with barbed wire, except that on all lots adjacent to fairway lots the rear fences shall be of wrought iron construction for a total fence height of five feet (5') black in color which shall continue along the side lot line for a distance of fifteen feet (15'). Access to the golf course from lots adjacent to the golf course is prohibited.

9. No individual water supply system (private well) shall be permitted on any lot in the subdivision.

10. No animals, livestock, birds or poultry of any kind shall be raised, bred or kept on any lot, provided, however, that personal pets such as dogs, cats or other household pets may be kept, but shall be fenced or leashed at all times.

11. No lot shall be used or allowed to become in such condition as to depreciate the value of adjacent property. No weeds, underbrush, unsightly growth, refuse piles, junk piles or other unsightly objects shall be permitted to be placed or to remain upon said lot. In the event of any owner not complying with the above provisions, the corporation whose members are the lot owners, Declarant, or its successor and assigns, shall have the right to enter upon the land and remove the offending objects at the expense of the owner, who shall repay the same upon demand, and such entry shall not be deemed a trespass.

12. No sign, advertisement, billboard or advertising structure of any kind shall be erected or allowed on any of the unimproved lots, and no signs shall be erected or allowed to remain on any lots, improved or otherwise, provided, however, that an owner may place on his improved lot "For Sale" signs, "For Lease" signs or "For Rent" signs so long as they are of reasonable dimensions.

13. All dwellings shall install water flush toilets, and all bathrooms, toilets or sanitary conveniences shall be inside the buildings constructed on said property. All bathrooms, toilets or sanitary conveniences shall be connected to central sewer. Septic tanks, cesspools and other individual sewage systems are expressly prohibited. Water and energy conservation devices including but not limited to toilets, shower heads, water heaters, and insulation shall be used whenever feasible. Low water use vegetation shall be used whenever possible in landscaping.

14. The storage of inoperative, damaged or junk motor vehicles and appliances and of tools, landscaping instruments, household effects, machinery or machinery parts, boats, trailers, empty or filled containers, boxes or bags, trash, materials, including used construction materials, or other items that shall in appearance detract from the aesthetic values of the property shall be so placed and stored to be concealed from the view of the public right-of-way and adjacent landowners. Trash for collection may be placed at the street right-of-way line on regular collection days for a period not to exceed twelve hours prior to pickup.

15. Under no circumstances shall any owner of any lot or parcel of land be permitted to deliberately alter the topographic conditions of his lot or parcel of land in any way that would permit additional quantities of water from any source other than what nature originally intended to flow from his property onto any adjoining property or public right-of-way, or redirect the flow.

16. No person shall use any premise in any land use area, which is designed, arranged or intended to be occupied or used for any purpose other than expressly permitted in this Declaration as set forth herein and in part "B" hereof. Multiple

1  
2  
3  
4  
5  
6  
7  
8  
9  
10  
11  
12  
13  
14  
15  
16  
17  
18  
19  
20  
21  
22  
23  
24  
25  
26  
27  
28

**Exhibit 3**

Excel Worksheet of APNs modified to fit seven pages.

Exhibit 3  
7 695

Note to the Court: The information provided in this worksheet was modified to fit 7 printed pages as an Exhibit. Original file available on request.

Count	APN	Site Address	Owner as of March 2020	Assessor's Property Description
1	226-13-001	5861 S DESERT LAKES DR	PIONEER TITLE TR 9051	DESERT LAKES GOLF COURSE & ESTATES TRACT 4076B BLK F LOT 10 CONT 7350 SQ FT
2	226-13-002	5867 S DESERT LAKES DR	ROYNO MICHAEL H & JUDITH M	DESERT LAKES GOLF COURSE & ESTATES TRACT 4076B BLK F LOT 11 CONT 7000 SQ FT
3	226-13-003	5879 S DESERT LAKES DR	COKER ELLSWORTH INC	DESERT LAKES GOLF COURSE & ESTATES TRACT 4076B BLK F LOT 12 CONT 7828 SQ FT
4	226-13-004	5885 S DESERT LAKES DR	KRAEMER BOYD A & LUANN R	DESERT LAKES GOLF COURSE & ESTATES TRACT 4076B BLK F LOT 13 CONT 8028 SQ FT
5	226-13-005	5891 S DESERT LAKES DR	KRAEMER BOYD	DESERT LAKES GOLF COURSE & ESTATES TRACT 4076B BLK F LOT 14 CONT 7567 SQ FT
6	226-13-007A	5895 S DESERT LAKES DR	RINDHED DESIREE	DESERT LAKES GOLF COURSE AND ESTATES TRACT 4076-B BLK F, LOTS 15 & 16 CONT. 13,772 SQFT
7	226-13-008	5903 S DESERT LAKES DR	LUDWIG GLEN & PEARLE TRS	DESERT LAKES GOLF COURSE & ESTATES TRACT 4076B BLK F LOT 17 CONT 6703 SQ FT
8	226-13-009	5905 S DESERT LAKES DR	GRICE GINA & JORDAN	DESERT LAKES GOLF COURSE & ESTATES TRACT 4076B BLK F LOT 18 CONT 7078 SQ FT
9	226-13-010	5909 S DESERT LAKES DR	BRUSH DAVID C	DESERT LAKES GOLF COURSE & ESTATES TRACT 4076B BLK F LOT 19 CONT 7100 SQ FT
10	226-13-011A	1889 E FAIRWAY DR	HASSETT JOHN	DESERT LAKES GOLF COURSE & ESTATES TRACT 4076B BLK F LOT 20 AND A POR OF PAR N-N
11	226-13-012	1886 E FAIRWAY BEND	TAYLOR ROBERT H & BELINDA D	DESERT LAKES GOLF COURSE & ESTATES TRACT 4076B BLK F LOT 21 CONT 6774 SQ FT
12	226-13-013	1882 E FAIRWAY BEND	HERRERA PROPERTY HOLDINGS LLC	DESERT LAKES GOLF COURSE & ESTATES TRACT 4076B BLK F LOT 22 CONT 6774 SQ FT
13	226-13-014	1878 E FAIRWAY BEND	PEREZ JOSEPH R	DESERT LAKES GOLF COURSE & ESTATES TRACT 4076B BLK F LOT 23 CONT 6872 SQ FT
14	226-13-015	1874 E FAIRWAY BEND	ADAM LARRY R & JANE B JT	DESERT LAKES GOLF COURSE & ESTATES TRACT 4076B BLK F LOT 24 CONT 6868 SQ FT
15	226-13-016	1872 E FAIRWAY BEND	BLACK JOSEPH M & MARY J	DESERT LAKES GOLF COURSE & ESTATES TRACT 4076B BLK F LOT 25 CONT 6868 SQ FT
16	226-13-017	1868 E FAIRWAY BEND	ALESTRA JOSE	DESERT LAKES GOLF COURSE & ESTATES TRACT 4076B BLK F LOT 26 CONT 6869 SQ FT
17	226-13-018	1866 E FAIRWAY BEND	ARAGON DAVID	DESERT LAKES GOLF COURSE & ESTATES TRACT 4076B BLK F LOT 27 CONT 6322 SQ FT
18	226-13-019	1864 E FAIRWAY BND	SEIFFERLEIN PAUL W & JANA S CPWRS	DESERT LAKES GOLF COURSE & ESTATES TRACT 4076B BLK F LOT 28 CONT 6006 SQ FT
19	226-13-020	1860 E FAIRWAY BEND	LAM CONSTRUCTION INC	DESERT LAKES GOLF COURSE & ESTATES TRACT 4076B BLK F LOT 29 CONT 6043 SQ FT
20	226-13-021	1858 E FAIRWAY BEND	BORDING-JORGENSEN ERLING & DOREEN JT	DESERT LAKES GOLF COURSE & ESTATES TRACT 4076B BLK F LOT 30 CONT 6004 SQ FT
21	226-13-022	1854 E FAIRWAY BEND	ILADA MELCHOR & DIGNACION TRS	DESERT LAKES GOLF COURSE & ESTATES TRACT 4076B BLK F LOT 31 CONT 6532 SQ FT
22	226-13-023	1852 E FAIRWAY BEND	BELL PAT J & MELINDA D	DESERT LAKES GOLF COURSE & ESTATES TRACT 4076B BLK F LOT 32 CONT 6,493 SQ FT
23	226-13-025A	1850 E FAIRWAY BEND	BELL PAT J & MELINDA D	DESERT LAKES GOLF COURSE & ESTATES TRACT 4076B BLK F LOTS 33 & 34 CONT 12,075 SQ FT
24	226-13-026	1846 E FAIRWAY BEND	KURT MAXINE J	DESERT LAKES GOLF COURSE & ESTATES TRACT 4076B BLK F LOT 35 CONT 6000 SQ FT
25	226-13-027	1844 E FAIRWAY BEND	CHOATE PETER J & ANTOINETTE M	DESERT LAKES GOLF COURSE & ESTATES TRACT 4076B BLK F LOT 36 CONT 6000 SQ FT
26	226-13-028	1840 E FAIRWAY BEND	GRADO MICHAEL C	DESERT LAKES GOLF COURSE & ESTATES TRACT 4076B BLK F LOT 37 CONT 6000 SQ FT
27	226-13-029	1838 E FAIRWAY BEND	HENDRIX RICHARD & STEPHANIE JT	DESERT LAKES GOLF COURSE & ESTATES TRACT 4076B BLK F LOT 38 CONT 6000 SQ FT
28	226-13-030	1834 E FAIRWAY BEND	WHITEFORD JOHN D & IKUKO CPWRS	DESERT LAKES GOLF COURSE & ESTATES TRACT 4076B BLK F LOT 39 CONT 6008 SQ FT
29	226-13-031	1830 E FAIRWAY BND	WILLIS JAMES W & THERESA N TRS	DESERT LAKES GOLF COURSE & ESTATES TRACT 4076B BLK F LOT 40 CONT 7212 SQ FT
30	226-13-032	1826 E FAIRWAY BEND	VALORE TERRY A & KARIN E	DESERT LAKES GOLF COURSE & ESTATES TRACT 4076B BLK F LOT 41 CONT 7591 SQ FT
31	226-13-033	1822 E FAIRWAY BEND	ANDERSON RALPH W & MARIE C	DESERT LAKES GOLF COURSE & ESTATES TRACT 4076B BLK F LOT 42 CONT 8411 SQ FT
32	226-13-034	1815 E FAIRWAY CIR	FELAND WADE G JT ETAL	DESERT LAKES GOLF COURSE & ESTATES TRACT 4076B BLK F LOT 43 CONT 8066 SQ FT
33	226-13-035	1813 E FAIRWAY CIR	HUGHES RICHARD J & KAREN S	DESERT LAKES GOLF COURSE & ESTATES TRACT 4076B BLK F LOT 44 CONT 7730 SQ FT
34	226-13-036	1812 E FAIRWAY CIR	PIONEER TITLE TR 9051	DESERT LAKES GOLF COURSE & ESTATES TRACT 4076B BLK F LOT 45 CONT 6943 SQ FT
35	226-13-037	1816 E FAIRWAY CIR	PIONEER TITLE TR 9051	DESERT LAKES GOLF COURSE & ESTATES TRACT 4076B BLK F LOT 46 CONT 6183 SQ FT
36	226-13-038	1820 E FAIRWAY CIR	PIONEER TITLE TR 9051	DESERT LAKES GOLF COURSE & ESTATES TRACT 4076B BLK F LOT 47 CONT 6186 SQ FT
37	226-13-039	1828 E FAIRWAY DR	PIONEER TITLE TR 9051	DESERT LAKES GOLF COURSE & ESTATES TRACT 4076B BLK F LOT 48 CONT 6132 SQ FT
38	226-13-040	1832 E FAIRWAY DR	BURKE MICHAEL M	DESERT LAKES GOLF COURSE & ESTATES TRACT 4076B BLK F LOT 49 CONT 6024 SQ FT
39	226-13-041	1836 E FAIRWAY DR	SPINDLER ROBERT D & JANICE L	DESERT LAKES GOLF COURSE & ESTATES TRACT 4076BBLK F LOT 50 CONT 6074 SQ FT
40	226-13-042	1842 E FAIRWAY DR	PIONEER INVESTMENTS & HOLDINGS LLC	DESERT LAKES GOLF COURSE & ESTATES TRACT 4076B BLK F LOT 51 CONT 6300 SQ FT
41	226-13-043	1854 E FAIRWAY DR	GRAHAM SHEREE	DESERT LAKES GOLF COURSE & ESTATES TRACT 4076B BLK F LOT 52 CONT 6300 SQ FT
42	226-13-044	1856 E FAIRWAY DR	THOMPSON FRANK & CARMEN CPWRS 25	DESERT LAKES GOLF COURSE & ESTATES TRACT 4076B BLK F LOT 53 CONT 6300 SQ FT
43	226-13-045	1862 E FAIRWAY DR	ISSAEVITCH THOMAS	DESERT LAKES GOLF COURSE & ESTATES TRACT 4076B BLK F LOT 54 CONT 6300 SQ FT
44	226-13-046	1870 E FAIRWAY DR	DSCHAAK RONNIE H & DEBORA J	DESERT LAKES GOLF COURSE & ESTATES TRACT 4076B BLK F LOT 55 CONT 6300 SQ FT

45	226-13-047	1876 E FAIRWAY DR	KINSELLA DAN & KELLY CPWRS	DESERT LAKES GOLF COURSE & ESTATES TRACT 4076B BLK F LOT 56 CONT 6300 SQ FT
46	226-13-048	1884 E FAIRWAY DR	LARUE SCOTT R & THERESA J CPWRS	DESERT LAKES GOLF COURSE & ESTATES TRACT 4076B BLK F LOT 57 CONT 6296 SQ FT
47	226-13-049	1890 E FAIRWAY DR	NAVARRO REAL ESTATE ENTERPRISES LLC ETAL	DESERT LAKES GOLF COURSE & ESTATES TRACT 4076B BLK F LOT 58 CONT 8313 SQ FT
48	226-13-050	1922 E FAIRWAY DR	SOBOTTA KARIN	DESERT LAKES GOLF COURSE & ESTATES TRACT 4076B BLK F LOT 59 CONT 6000 SQ FT
49	226-13-051	1926 E FAIRWAY DR	REES LEWIS & DOLORES JT	DESERT LAKES GOLF COURSE & ESTATES TRACT 4076B BLK F LOT 60 CONT 6000 SQ FT
50	226-13-052	1932 E FAIRWAY DR	EURICH RICHARD K	DESERT LAKES GOLF COURSE & ESTATES TRACT 4076B BLK F LOT 61 CONT 6369 SQ FT
51	226-13-053	1944 E FAIRWAY DR	ERNY CECELIA	DESERT LAKES GOLF COURSE & ESTATES TRACT 4076B BLK F LOT 62 CONT 6369 SQ FT
52	226-13-054	1948 E FAIRWAY DR	MARTINEAU GREGORY W & LINDA S	DESERT LAKES GOLF COURSE & ESTATES TRACT 4076B BLK F LOT 63 CONT 6369 SQ FT
53	226-13-055	1952 E FAIRWAY DR	HAUGEN JAMES & JANE TRUSTEES	DESERT LAKES GOLF COURSE & ESTATES TRACT 4076B BLK F LOT 64 CONT 6369 SQ FT
54	226-13-056	1960 E FAIRWAY DR	MOSANSKY JEFFREY E & FELIX F	DESERT LAKES GOLF COURSE & ESTATES TRACT 4076B BLK F LOT 65 CONT 6369 SQ FT
55	226-13-057	1964 E FAIRWAY DR	DRYG EDWARD J & BARBARA TRUSTEES	DESERT LAKES GOLF COURSE & ESTATES TRACT 4076B BLK F LOT 66 CONT 6369 SQ FT
56	226-13-058	1968 E FAIRWAY DR	HAUGEN JAMES A & JANE M TRUSTEES	DESERT LAKES GOLF COURSE & ESTATES TRACT 4076B BLK F LOT 67 CONT 6369 SQ FT
57	226-13-059	1972 E FAIRWAY DR	DANCS LOUIS & ILDIKO K CO-TRUSTEES	DESERT LAKES GOLF COURSE & ESTATES TRACT 4076B BLK F LOT 68 CONT 6603 SQ FT
58	226-13-060	5913 S DESERT LAKES DR	EMERY KENNETH B & MARJORIE CPWRS	DESERT LAKES GOLF COURSE & ESTATES TRACT 4076B BLK F LOT 69 CONT 7743 SQ FT
59	226-13-061	5919 S DESERT LAKES DR	HUBBARD JAMES T	DESERT LAKES GOLF COURSE & ESTATES TRACT 4076B BLK F LOT 70 CONT 6355 SQ FT
60	226-13-062	5923 S DESERT LAKES DR	PIONEER TITLE TR 9051	DESERT LAKES GOLF COURSE & ESTATES TRACT 4076B BLK F LOT 71 CONT 6112 SQ FT
61	226-13-063	5927 S DESERT LAKES DR	SUNG KENG & CHANTHOU CPWRS	DESERT LAKES GOLF COURSE & ESTATES TRACT 4076B BLK F LOT 72 CONT 6105 SQ FT
62	226-13-064	5931 S DESERT LAKES DR	SHAFFER ROBERT A & JACQUELYN M	DESERT LAKES GOLF COURSE & ESTATES TRACT 4076B BLK F LOT 73 CONT 6173 SQ FT
63	226-13-065	5935 S DESERT LAKES DR	HALLER GLENN & REBECCA	DESERT LAKES GOLF COURSE & ESTATES TRACT 4076B BLK F LOT 74 CONT 7358 SQ FT
64	226-13-078	1957 E LIPAN BLVD	HUEBNER RICHARD C TRUSTEE	DESERT LAKES GOLF COURSE & ESTATES TRACT 4076B BLK F LOT 87 CONT 6300 SQ FT
65	226-13-079	1953 E LIPAN BLVD	BIESSENER BRUCE & JERSETS JOAN	DESERT LAKES GOLF COURSE & ESTATES TRACT 4076B BLK F LOT 88 CONT 6300 SQ FT
66	226-13-080	1949 E LIPAN BLVD	SOLARIO RUBEN & ROSEMARIE JT	DESERT LAKES GOLF COURSE & ESTATES TRACT 4076B BLK F LOT 89 CONT 6300 SQ FT
67	226-13-081	1945 E LIPAN BLVD	BRAZEAL MARGIE	DESERT LAKES GOLF COURSE & ESTATES TRACT 4076B BLK F LOT 90 CONT 6300 SQ FT
68	226-13-082	1933 E LIPAN BLVD	LUDWIG GLEN & PEARLE TR	DESERT LAKES GOLF COURSE & ESTATES TRACT 4076B BLK F LOT 91 CONT 6300 SQ FT
69	226-13-083	1927 E LIPAN BLVD	FAIRWAY CONSTRUCTORS	DESERT LAKES GOLF COURSE & ESTATES TRACT 4076B BLK F LOT 92 CONT 6300 SQ FT
70	226-13-084	1921 E LIPAN BLVD	FOUST DONALD E & VIRGINIA A	DESERT LAKES GOLF COURSE & ESTATES TRACT 4076B BLK F LOT 93 CONT 6300 SQ FT
71	226-13-085	1917 E LIPAN BLVD	COSTA DONALD TRUSTEE	DESERT LAKES GOLF COURSE & ESTATES TRACT 4076B BLK F LOT 94 CONT 6300 SQ FT
72	226-13-086	1909 E LIPAN BLVD	MC HUGH DANIEL J & LAURA TRUSTEES	DESERT LAKES GOLF COURSE & ESTATES TRACT 4076B BLK F LOT 95 CONT 6300 SQ FT
73	226-13-087	1903 E LIPAN BLVD	CONKLIN WALTER E ETAL JT	DESERT LAKES GOLF COURSE & ESTATES TRACT 4076B BLK F LOT 96 CONT 6300 SQ FT
74	226-13-088	1895 E LIPAN BLVD	HULTMAN DIANE Y	DESERT LAKES GOLF COURSE & ESTATES TRACT 4076B BLK F LOT 97 CONT 6300 SQ FT
75	226-13-089	1887 E LIPAN BLVD	KENNISTON JIMMY & SUSAN CPWRS	DESERT LAKES GOLF COURSE & ESTATES TRACT 4076B BLK F LOT 98 CONT 6300 SQ FT
76	226-13-090	1883 E LIPAN BLVD	MC HUGH DANIEL J & LAURA M TRUSTEES	DESERT LAKES GOLF COURSE & ESTATES TRACT 4076B BLK F LOT 99 CONT 6300 SQ FT
77	226-13-091	1879 E LIPAN BLVD	THOMAS MICHAEL E & SANDRA JEAN LORD JT	DESERT LAKES GOLF COURSE & ESTATES TRACT 4076B BLK F LOT 100 CONT 6300 SQ FT
78	226-13-092	1875 E LIPAN BLVD	HEARN PATRICIA A RASMUSSEN	DESERT LAKES GOLF COURSE & ESTATES TRACT 4076B BLK F LOT 101 CONT 6300 SQ FT
79	226-13-093	1869 E LIPAN BLVD	BRIC INVESTMENTS INC	DESERT LAKES GOLF COURSE & ESTATES TRACT 4076B BLK F LOT 102 CONT 6300 SQ FT
80	226-13-094	1863 E LIPAN BLVD	HAYDEN WILLIAM J & CHARLOTTE CO-TRUSTEE:	DESERT LAKES GOLF COURSE & ESTATES TRACT 4076B BLK F LOT 103 CONT 6300 SQ FT
81	226-13-095	1857 E LIPAN BLVD	SUNNE DOUGLAS & CHERYL	DESERT LAKES GOLF COURSE & ESTATES TRACT 4076B BLK F LOT 104 CONT 6300 SQ FT
82	226-13-096	1851 E LIPAN BLVD	SANDOVAL RODNEY A	DESERT LAKES GOLF COURSE & ESTATES TRACT 4076B BLK F LOT 105 CONT 6300 SQ FT
83	226-13-097	1845 E LIPAN BLVD	AGALSOFF RONALD	DESERT LAKES GOLF COURSE & ESTATES TRACT 4076B BLK F LOT 106 CONT 6300 SQ FT
84	226-13-098	1839 E LIPAN BLVD	GRICE JORDAN C & GINA	DESERT LAKES GOLF COURSE & ESTATES TRACT 4076B BLK F LOT 107 CONT 6300 SQ FT
85	226-13-100A	1831 E LIPAN BLVD	JOHNSON CHARLES A & DIANNA TRUSTEES	DESERT LAKES GOLF COURSE & ESTATES TRACT 4076B BLK F LOTS 108 & 109 CONT 13619 SQ FT
86	226-13-101	1821 E LIPAN BLVD	FIXSEN CARY ETAL	DESERT LAKES GOLF COURSE & ESTATES TRACT 4076B BLK F LOT 110 CONT 6518 SQ FT
87	226-13-102	E FAIRWAY	BOYETT CRAIG A	DESERT LAKES GOLF COURSE & ESTATES TRACT 4076B BLK G LOT 1 CONT 6914 SQ FT
88	226-13-103	1875 E FAIRWAY DR	HESS ROBERT E JR & BRITNIE C	DESERT LAKES GOLF COURSE & ESTATES TRACT 4076B BLK G LOT 2 CONT 6100 SQ FT
89	226-13-104	1881 E FAIRWAY DR	TSEKO PAUL R JR & AMY L	DESERT LAKES GOLF COURSE & ESTATES TRACT 4076B BLK G LOT 3 CONT 6914 SQ FT
90	226-13-105	1879 E FAIRWAY BEND	PEMBERTON WILLIAM & JUDY CPWRS	DESERT LAKES GOLF COURSE & ESTATES TRACT 4076B BLK G LOT 4 CONT 6454 SQ FT
91	226-13-106	1873 E FAIRWAY BEND	DURNIL DIONNE	DESERT LAKES GOLF COURSE & ESTATES TRACT 4076B BLK G LOT 5 CONT 6867 SQ FT

92	226-13-107	1871 E FAIRWAY BEND	STREETER GERALD & JUDITH	DESERT LAKES GOLF COURSE & ESTATES TRACT 40768 BLK G LOT 6 CONT 6887 SQ FT
93	226-13-108	1865 E FAIRWAY BEND	ASQUITH MICHAEL J & LYNDIA S CPWRS	DESERT LAKES GOLF COURSE & ESTATES TRACT 40768 BLK G LOT 7 CONT 7099 SQ FT
94	226-13-109	1863 E FAIRWAY BEND	LANDS JAMES T	DESERT LAKES GOLF COURSE & ESTATES TRACT 40768 BLK G LOT 8 CONT 6159 SQ FT
95	226-13-110	1853 E FAIRWAY BEND	COCHRAN DAVID E & MARY E	DESERT LAKES GOLF COURSE & ESTATES TRACT 40768 BLK G LOT 9 CONT 8059 SQ FT
96	226-13-111	1849 E FAIRWAY BEND	WADE DENNIS L & SHARON J JT	DESERT LAKES GOLF COURSE & ESTATES TRACT 40768 BLK G LOT 10 CONT 6002 SQ FT
97	226-13-112	1845 E FAIRWAY BEND	BERARD DAVID EDWARD & RAGNHILD OLIVIA JT	DESERT LAKES GOLF COURSE & ESTATES TRACT 40768 BLK G LOT 11 CONT 6000 SQ FT
98	226-13-113	1841 E FAIRWAY BEND	MATA JUAN C	DESERT LAKES GOLF COURSE & ESTATES TRACT 40768 BLK G LOT 12 CONT 6000 SQ FT
99	226-13-114	1837 E FAIRWAY BEND	DOIZAKI ERNEST Y & KIVO ETAL JT	DESERT LAKES GOLF COURSE & ESTATES TRACT 40768 BLK G LOT 13 CONT 6000 SQ FT
100	226-13-115	1835 E FAIRWAY BEND	GARCIA MELINA	DESERT LAKES GOLF COURSE & ESTATES TRACT 40768 BLK G LOT 14 CONT 6205 SQ FT
101	226-13-116	1833 E FAIRWAY DR	WILHELM FRANK & COLLEEN JT	DESERT LAKES GOLF COURSE & ESTATES TRACT 40768 BLK G LOT 15 CONT 7901 SQ FT
102	226-13-117	1839 E FAIRWAY DR	GREENWOOD LAWRENCE M & MAXINE A JT	DESERT LAKES GOLF COURSE & ESTATES TRACT 40768 BLK G LOT 16 CONT 6500 SQ FT
103	226-13-118	1847 E FAIRWAY DR	BAKER ALEXANDRA	DESERT LAKES GOLF COURSE & ESTATES TRACT 40768 BLK G LOT 17 CONT 6500 SQ FT
104	226-13-119	1855 E FAIRWAY DR	MC DONALD JOHN	DESERT LAKES GOLF COURSE & ESTATES TRACT 40768 BLK G LOT 18 CONT 7176 SQ FT
105	226-13-120	1857 E FAIRWAY CT	NDECHE STEPHEN C & GLADYS C	DESERT LAKES GOLF COURSE & ESTATES TRACT 40768 BLK G LOT 19 CONT 8073 SQ FT
	226-13-121	1861 E FAIRWAY CT	PIONEER INVESTMENTS & HOLDINGS LLC	DESERT LAKES GOLF COURSE & ESTATES TRACT 40768 BLK G LOT 20 CONT 7256 SQ FT
	226-13-122	1863 E FAIRWAY CT	CARTER JOE E & MARY NANETTE TRUSTEES	DESERT LAKES GOLF COURSE & ESTATES TRACT 40768 BLK G LOT 21 CONT 9959 SQ FT
108	226-13-123	1865 E FAIRWAY CT	TONTILLO SHIRLEY	DESERT LAKES GOLF COURSE AND ESTATES TR 4076-8 LOT 15-A CONT 7429 SQ FT
109	226-13-124A	5846 S DESERT LAKES DR	KREUTER JAMES S	DESERT LAKES GOLF COURSE & ESTATES TRACT 40768 BLK H LOT 16 CONT 6216 SQ FT
110	226-13-125	5852 S DESERT LAKES DR	WILKINS KENNETH W	DESERT LAKES GOLF COURSE & ESTATES TRACT 40768 BLK H LOT 17 CONT 6489 SQ FT
111	226-13-126	5858 S DESERT LAKES DR	JAMNEAD PARVIN	DESERT LAKES GOLF COURSE & ESTATES TRACT 40768 BLK H LOT 18 CONT 7450 SQ FT
112	226-13-127	5864 S DESERT LAKES DR	PALMISANO SUSAN	DESERT LAKES GOLF COURSE & ESTATES TRACT 40768 BLK H LOT 19 CONT 8901 SQ FT
113	226-13-128	5870 S DESERT LAKES DR	PAYNE LARRY D & BETTY J	DESERT LAKES GOLF COURSE & ESTATES TRACT 40768 BLK H LOTS 20 & 21 CONT 20015 SQ FT
114	226-13-130A	5882 S DESERT LAKES DR	KAISER PETER H & MARLAINE	DESERT LAKES GOLF COURSE & ESTATES TRACT 40768 BLK H LOT 22 CONT 11543 SQ FT
115	226-13-131	5888 S DESERT LAKES DR	RAMIREZ JESUS	DESERT LAKES GOLF COURSE & ESTATES TRACT 40768 BLK H LOT 23 CONT 8427 SQ FT
116	226-13-132	1957 E DESERT LAKES PL	MARCH DAVID TRUSTEE	DESERT LAKES GOLF COURSE & ESTATES TRACT 40768 BLK H LOT 24 CONT 8040 SQ FT
117	226-13-133	1963 E DESERT LAKES PL	PANOS LEON JT ETAL	DESERT LAKES GOLF COURSE & ESTATES TRACT 40768 BLK H LOT 25 CONT 10545 SQ FT
118	226-13-134	1962 E DESERT LAKES PL	JOHNSON HOWARD R & JUDI	DESERT LAKES GOLF COURSE & ESTATES TRACT 40768 BLK H LOT 26 CONT 9730 SQ FT
119	226-13-135	1958 E DESERT LAKES PL	ABATE DIANE M ETAL	DESERT LAKES GOLF COURSE & ESTATES TRACT 40768 BLK H LOT 27 CONT 8848 SQ FT
120	226-13-136	5894 S DESERT LAKES DR	FAROOQI SAM A & LILY W TRUSTEES	DESERT LAKES GOLF COURSE & ESTATES TRACT 40768 BLK H LOT 28 CONT 9595 SQ FT
121	226-13-137	5900 E DESERT LAKES DR	JIMM LIVING TRUST	DESERT LAKES GOLF COURSE & ESTATES TRACT 40768 BLK H LOT 29 CONT 9296 SQ FT
122	226-13-138	5906 S DESERT LAKES DR	BURNELL ANNE	DESERT LAKES GOLF COURSE & ESTATES TRACT 40768 BLK H LOT 30 CONT 9870 SQ FT
123	226-13-139	1977 E FAIRWAY PL	PLOUGH ALEXIS K	DESERT LAKES GOLF COURSE & ESTATES TRACT 40768 BLK H LOT 31 CONT 11167 SQ FT
124	226-13-140	1979 E FAIRWAY PL	BROCKER GLENN H & TERESA L	DESERT LAKES GOLF COURSE & ESTATES TRACT 40768 BLK H LOT 32 CONT 14243 SQ FT
125	226-13-141	1981 E FAIRWAY PL	JAMNEAD PARVIN	DESERT LAKES GOLF COURSE & ESTATES TRACT 40768 BLK H LOT 33 CONT 8761 SQ FT
126	226-13-142	1982 E FAIRWAY PL	WALASZEK DALE	DESERT LAKES GOLF COURSE & ESTATES TRACT 40768 BLK H LOT 34 CONT 9020 SQ FT
127	226-13-143	1978 E FAIRWAY PL	BARTOLONE JOSEPH C & ROSE TRUSTEES	DESERT LAKES GOLF COURSE & ESTATES TRACT 40768 BLK H LOT 35 CONT 8560 SQ FT
128	226-13-144	1976 E FAIRWAY PL	PAGANO NICHOLAS & ANNE M TRUSTEES	DESERT LAKES GOLF COURSE & ESTATES TRACT 40768 BLK H LOT 36 CONT 8870 SQ FT
129	226-13-145	5912 E DESERT LAKES DR	WOLGAMOTT WALTER D & VALERIE H TRUSTEE	DESERT LAKES GOLF COURSE & ESTATES TRACT 40768 BLK H LOT 37 CONT 9258 SQ FT
130	226-13-146	5924 S DESERT LAKES DR	DINKIN ALAN J	DESERT LAKES GOLF COURSE & ESTATES TRACT 40768 BLK H LOT 38 CONT 10979 SQ FT
131	226-13-147	5932 S DESERT LAKES DR	OECHSNER ROBERT & SANDRA CO-TRUSTEES	DESERT LAKES GOLF COURSE AND ESTATES TR 4076-8 BLK H LOT 39
132	226-13-148A	1994 E DESERT GREENS DR	WILSON NICOLLE	DESERT LAKES GOLF COURSE & ESTATES TRACT 40768 BLK H LOT 40 CONT 6175 SQ FT
133	226-13-149	1988 E DESERT GREENS DR	LUDWIG GLEN L & PEARLE A	DESERT LAKES GOLF COURSE & ESTATES TRACT 40768 BLK H LOT 41 CONT 7627 SQ FT
134	226-13-150	1980 E DESERT GREENS DR	KOHL DAVID A & CHRISTINE A	DESERT LAKES GOLF COURSE & ESTATES TRACT 40768 BLK H LOT 42 CONT 7238 SQ FT
135	226-13-151	1976 E DESERT GREENS DR	COFFEY MARTIN & LAURA	DESERT LAKES GOLF COURSE & ESTATES TRACT 40768 BLK H LOT 43 CONT 6588 SQ FT
136	226-13-152	1968 E DESERT GREENS DR	BLACK JOSEPH M & MARY TRS 50	DESERT LAKES GOLF COURSE & ESTATES TRACT 40768 BLK H LOT 44 CONT 6000 SQ FT
137	226-13-153	1962 E DESERT GREENS DR	ALESON DOUGLAS A & CAROL A JT	DESERT LAKES GOLF COURSE & ESTATES TRACT 40768 BLK H LOT 45 CONT 6500 SQ FT
138	226-13-154	1956 E DESERT GREENS DR	VIGNONI JOHN & MONTGOMERY DONNA	DESERT LAKES GOLF COURSE & ESTATES TRACT 40768 BLK H LOT 45 CONT 6500 SQ FT

3 of 7

139	226-13-155	1948 E DESERT GREENS DR	TRUONG CAM	DESERT LAKES GOLF COURSE & ESTATES TRACT 4076B BLK H LOT 46 CONT 6500 SQ FT
140	226-13-156	1942 E DESERT GREENS DR	WRIGHT NICHOLAS F	DESERT LAKES GOLF COURSE & ESTATES TRACT 4076B BLK H LOT 47 CONT 6500 SQ FT
141	226-13-157	1936 E DESERT GREENS DR	AZARMI AMIR M & JAMNEJAD AZAR D	DESERT LAKES GOLF COURSE & ESTATES TRACT 4076B BLK H LOT 48 CONT 6500 SQ FT
142	226-13-158	1930 E DESERT GREENS DR	GAUCI GABRIELLE	DESERT LAKES GOLF COURSE & ESTATES TRACT 4076B BLK H LOT 49 CONT 6500 SQ FT
143	226-13-159	1922 E DESERT GREENS DR	DEAN WILLIAM	DESERT LAKES GOLF COURSE & ESTATES TRACT 4076B BLK H LOT 50 CONT 6500 SQ FT
144	226-13-160	1914 E DESERT GREENS DR	BOSKOVICH WALTER J & BARBARA A TRUSTEES	DESERT LAKES GOLF COURSE & ESTATES TRACT 4076B BLK H LOT 51 CONT 7043 SQ FT
145	226-13-161A	1911 E DESERT DR	NESS MORLEY E & MARY C TRUSTEES	DESERT LAKES GOLF COURSE AND ESTATES TRACT 4076-B ABANDONED LOTS 52-A, ...
146	226-13-162	1915 E DESERT DR	MILLER WILMA EARNESTINE TRUSTEE	DESERT LAKES GOLF COURSE & ESTATES TRACT 4076B BLK H LOT 53 CONT 7346 SQ FT
147	226-13-163	1921 E DESERT DR	JOHNSON CARL E & BEVERLY A TRUSTEES	DESERT LAKES GOLF COURSE & ESTATES TRACT 4076B BLK H LOT 54 CONT 6000 SQ FT
148	226-13-164	1927 E DESERT DR	DELVRIA DARREL D & MARIA G	DESERT LAKES GOLF COURSE & ESTATES TRACT 4076B BLK H LOT 55 CONT 6000 SQ FT
149	226-13-165	1933 E DESERT DR	HUNTER JAMES & TYREE TRUSTEES	DESERT LAKES GOLF COURSE & ESTATES TRACT 4076B BLK H LOT 56 CONT 6000 SQ FT
150	226-13-166	1939 E DESERT DR	HUNTER JAMES & TYREE TRUSTEES	DESERT LAKES GOLF COURSE & ESTATES TRACT 4076B BLK H LOT 57 CONT 6000 SQ FT
151	226-13-167	1945 E DESERT DR	AZARMI AMIR M & JAMNEJAD AZAR D	DESERT LAKES GOLF COURSE & ESTATES TRACT 4076B BLK H LOT 58 CONT 6000 SQ FT
152	226-13-168	1951 E DESERT DR	MILLER RONALD J & SHIRLEY D	DESERT LAKES GOLF COURSE & ESTATES TRACT 4076B BLK H LOT 59 CONT 6000 SQ FT
	226-13-169	1959 E DESERT DR	DAVIDE DEWEY D	DESERT LAKES GOLF COURSE & ESTATES TRACT 4076B BLK H LOT 60 CONT 6000 SQ FT
	226-13-170	1963 E DESERT DR	HARRIS LOUISE	DESERT LAKES GOLF COURSE & ESTATES TRACT 4076B BLK H LOT 61 CONT 6000 SQ FT
	226-13-171	1967 E DESERT DR	STORTZ KIRBY R JR & CLAIRE L JT	DESERT LAKES GOLF COURSE & ESTATES TRACT 4076B BLK H LOT 62 CONT 6098 SQ FT
155	226-13-172	1971 E DESERT DR	PORTER RONALD J & JUDITH F	DESERT LAKES GOLF COURSE & ESTATES TRACT 4076B BLK H LOT 63 CONT 6850 SQ FT
156	226-13-173	1975 E DESERT DR	HORNE JAMES J & CARI D	DESERT LAKES GOLF COURSE & ESTATES TRACT 4076B BLK H LOT 64 CONT 8275 SQ FT
157	226-13-174	1979 E DESERT DR	RYBURN BILLY M	DESERT LAKES GOLF COURSE & ESTATES TRACT 4076B BLK H LOT 65 CONT 9319 SQ FT
158	226-13-175	1983 E DESERT DR	PIONEER TITLE TR 9051	DESERT LAKES GOLF COURSE & ESTATES TRACT 4076B BLK H LOT 66 CONT 7827 SQ FT
159	226-13-176	1987 E DESERT DR	GARCIA PAUL C JR & VALERIE JT	DESERT LAKES GOLF COURSE & ESTATES TRACT 4076B BLK H LOT 67 CONT 7000 SQ FT
160	226-13-177	1993 E DESERT DR	PIONEER TITLE TR 9051	DESERT LAKES GOLF COURSE & ESTATES TRACT 4076B BLK H LOT 68 CONT 8724 SQ FT
161	226-13-178	1992 E DESERT DR	PIERCE JAMES JT 50	DESERT LAKES GOLF COURSE & ESTATES TRACT 4076B BLK H LOT 1 CONT 7804 SQ FT
162	226-13-179	1986 E DESERT DR	PIONEER TITLE TR 9051	DESERT LAKES GOLF COURSE & ESTATES TRACT 4076B BLK H LOT 2 CONT 6188 SQ FT
163	226-13-180	1982 E DESERT DR	PARKS ELMER & KAY	DESERT LAKES GOLF COURSE & ESTATES TRACT 4076B BLK H LOT 3 CONT 6188 SQ FT
164	226-13-181	1978 E DESERT DR	PIONEER TITLE TR 9051	DESERT LAKES GOLF COURSE & ESTATES TRACT 4076B BLK H LOT 4 CONT 6592 SQ FT
165	226-13-182	1970 E DESERT DR	MARTIN BRANDON	DESERT LAKES GOLF COURSE & ESTATES TRACT 4076B BLK H LOT 5 CONT 6581 SQ FT
166	226-13-183	1964 E DESERT DR	KOCH MICHAEL A & CAROL A JT	DESERT LAKES GOLF COURSE & ESTATES TRACT 4076B BLK H LOT 6 CONT 6000 SQ FT
167	226-13-184	1960 DESERT DR	TOPPING JED & LISLE CPWRS	DESERT LAKES GOLF COURSE & ESTATES TRACT 4076B BLK H LOT 7 CONT 6000 SQ FT
168	226-13-185	1954 E DESERT DR	MARASCO JAMES JOHN & HEATHER MARIE	DESERT LAKES GOLF COURSE & ESTATES TRACT 4076B BLK H LOT 8 CONT 6000 SQ FT
169	226-13-186	1946 E DESERT DR	GARCIA BEN JR & PATSY CPWRS	DESERT LAKES GOLF COURSE & ESTATES TRACT 4076B BLK H LOT 9 CONT 6000 SQ FT
170	226-13-187	1940 E DESERT DR	WARNER LORI TRUSTEE	DESERT LAKES GOLF COURSE & ESTATES TRACT 4076B BLK H LOT 10 CONT 6000 SQ FT
171	226-13-188	1934 E DESERT DR	OLSON DIANA L	DESERT LAKES GOLF COURSE & ESTATES TRACT 4076B BLK H LOT 11 CONT 6000 SQ FT
172	226-13-189	1928 E DESERT DR	HUNT HAROLD G & KRISTIE L CPWRS	DESERT LAKES GOLF COURSE & ESTATES TRACT 4076B BLK H LOT 12 CONT 6000 SQ FT
173	226-13-190	1920 E DESERT DR	MAIALE ENRICO M & FRANCENE	DESERT LAKES GOLF COURSE & ESTATES TRACT 4076B BLK H LOT 13 CONT 8278 SQ FT
174	226-13-191	1929 E DESERT GREENS DR	PANASUK ANDREW F TRUSTEE	DESERT LAKES GOLF COURSE & ESTATES TRACT 4076B BLK H LOT 14 CONT 6014 SQ FT
175	226-13-192	1935 E DESERT GREENS LN	ALLEN WAYNE L & CAROLE L	DESERT LAKES GOLF COURSE & ESTATES TRACT 4076B BLK H LOT 15 CONT 6000 SQ FT
176	226-13-193	1941 E DESERT GREENS LN	CONTREAS ANTHONY ROBERT	DESERT LAKES GOLF COURSE & ESTATES TRACT 4076B BLK H LOT 16 CONT 6000 SQ FT
177	226-13-194	1947 E DESERT GREENS LN	LAIRD LEON & MARYJO CPWRS	DESERT LAKES GOLF COURSE & ESTATES TRACT 4076B BLK H LOT 17 CONT 6000 SQ FT
178	226-13-195	1955 E DESERT GREENS LN	BRUMMOND RICHARD S & SWEET BRUMMOND	DESERT LAKES GOLF COURSE & ESTATES TRACT 4076B BLK H LOT 18 CONT 6000 SQ FT
179	226-13-196	1961 E DESERT GREENS LN	COLIUNNO JODY	DESERT LAKES GOLF COURSE & ESTATES TRACT 4076B BLK H LOT 19 CONT 6000 SQ FT
180	226-13-197	1969 E DESERT GREENS LN	LAWSON DALE A	DESERT LAKES GOLF COURSE & ESTATES TRACT 4076B BLK H LOT 20 CONT 6396 SQ FT
181	226-13-198	1977 E DESERT GREENS LN	RUSSELL ERIC	DESERT LAKES GOLF COURSE & ESTATES TRACT 4076B BLK H LOT 21 CONT 7378 SQ FT
182	226-13-199	1981 E DESERT GREENS LN	RUIZ STEVE M	DESERT LAKES GOLF COURSE & ESTATES TRACT 4076B BLK H LOT 22 CONT 7622 SQ FT
183	226-13-200	1989 E DESERT GREENS LN	RUIZ JOSEPH A	DESERT LAKES GOLF COURSE & ESTATES TRACT 4076B BLK H LOT 23 CONT 7981 SQ FT
184	226-13-201	1991 E DESERT GREENS LN	SWEENEY DAWN	DESERT LAKES GOLF COURSE & ESTATES TRACT 4076B BLK H LOT 24 CONT 9352 SQ FT

407

186	226-13-202	1990 E DESERT GREENS LN	SINGER RANDY G & LINDA E	DESERT LAKES GOLF COURSE & ESTATES TRACT 4076B BLK J LOT 1 CONT 8851 SQ FT
187	226-13-203	1984 E DESERTS GREENS LN	OLIVER ERIC M & KELLY C	DESERT LAKES GOLF COURSE & ESTATES TRACT 4076B BLK J LOT 2 CONT 7472 SQ FT
188	226-13-204	1972 E DESERT GREENS LN	FELIX IGNACIO CPWRS ETAL	DESERT LAKES GOLF COURSE & ESTATES TRACT 4076B BLK J LOT 3 CONT 7317 SQ FT
189	226-13-205	1966 E DESERT GREENS LN	ABRAMIAN ALFRED	DESERT LAKES GOLF COURSE & ESTATES TRACT 4076B BLK J LOT 4 CONT 6120 SQ FT
190	226-13-206	1958 E DESERT GREENS LN	KNIGHT DONALD G & ELVIRA Q	DESERT LAKES GOLF COURSE & ESTATES TRACT 4076B BLK J LOT 5 CONT 6000 SQ FT
191	226-13-207	1952 E DESERT GREENS LN	ROBINSON DALE W TRUSTEE	DESERT LAKES GOLF COURSE & ESTATES TRACT 4076B BLK J LOT 6 CONT 6000 SQ FT
192	226-13-208	1944 E DESERT GREENS LN	PLODZIN RICHARD & DIANA	DESERT LAKES GOLF COURSE & ESTATES TRACT 4076B BLK J LOT 7 CONT 6000 SQ FT
193	226-13-209	1938 E DESERT GREENS LN	HARRIS GARY L & BONNIE K CO-TRUSTEES	DESERT LAKES GOLF COURSE & ESTATES TRACT 4076B BLK J LOT 8 CONT 6000 SQ FT
194	226-13-210	1932 E DESERT GREENS LN	SMITH JASON M & HEIDI	DESERT LAKES GOLF COURSE & ESTATES TRACT 4076B BLK J LOT 9 CONT 7773 SQ FT
195	226-13-211	1945 E SUNSET DR	TIBERIO RICKY & YOLLANDA JT	DESERT LAKES GOLF COURSE & ESTATES TRACT 4076B BLK J LOT 10 CONT 6769 SQ FT
196	226-13-212	1953 E SUNSET DR	BROWN SHARON L	DESERT LAKES GOLF COURSE & ESTATES TRACT 4076B BLK J LOT 11 CONT 6000 SQ FT
197	226-13-213	1959 E SUNSET DR	MONARREZ MANUEL M	DESERT LAKES GOLF COURSE & ESTATES TRACT 4076B BLK J LOT 12 CONT 6000 SQ FT
198	226-13-214	1967 E SUNSET DR	LOW MARILYN TRUSTEE	DESERT LAKES GOLF COURSE & ESTATES TRACT 4076B BLK J LOT 13 CONT 6002 SQ FT
199	226-13-215	1971 E SUNSET DR	LOW MARILYN TRUSTEE	DESERT LAKES GOLF COURSE & ESTATES TRACT 4076B BLK J LOT 14 CONT 6565 SQ FT
	226-13-216	1979 E SUNSET DR	GUALENI DAVID V & TERRI E	DESERT LAKES GOLF COURSE & ESTATES TRACT 4076B BLK J LOT 15 CONT 7117 SQ FT
	226-13-217	1985 E SUNSET DR	BALDSCHUN DAVE & MARTHA CPWRS	DESERT LAKES GOLF COURSE & ESTATES TRACT 4076B BLK J LOT 16 CONT 6362 SQ FT
202	226-13-218	1995 E SUNSET DR	FILLPOT WILLIAM C & NANCY A	DESERT LAKES GOLF COURSE & ESTATES TRACT 4076B BLK J LOT 17 CONT 8066 SQ FT
203	226-13-219	1994 E SUNSET DR	CHAMBERS FRANK & YAWALUCK JT	DESERT LAKES GOLF COURSE & ESTATES TRACT 4076B BLK K LOT 1 CONT 9992 SQ FT
204	226-13-220	1976 E SUNSET DR	OLIVER CHRISTOPHER S	DESERT LAKES GOLF COURSE & ESTATES TRACT 4076B BLK K LOT 2 CONT 9090 SQ FT
205	226-13-221	1964 E SUNSET DR	ALVARADO BRYAN	DESERT LAKES GOLF COURSE & ESTATES TRACT 4076B BLK K LOT 3 CONT 8211 SQ FT
206	226-13-222	1965 E DESERT GREENS DR	GAMBRELL JONATHAN R & SARAH N	DESERT LAKES GOLF COURSE & ESTATES TRACT 4076B BLK K LOT 4 CONT 9744 SQ FT
207	226-13-223	1977 E DESERT GREENS DR	DOYLE GERALD	DESERT LAKES GOLF COURSE & ESTATES TRACT 4076B BLK K LOT 5 CONT 8987 SQ FT
208	226-13-224	1985 E DESERT GREENS DR	MILLER EDWARD M	DESERT LAKES GOLF COURSE & ESTATES TRACT 4076B BLK K LOT 6 CONT 9846 SQ FT
209	226-13-225	1995 E DESERT GREENS DR	THAMES JONATHAN R & GINA	DESERT LAKES GOLF COURSE & ESTATES TRACT 4076B BLK K LOT 7 CONT 10400 SQ FT
210	226-13-226	See mailing address	UNITED STATES OF AMERICA TRUSTEE	DESERT LAKES GOLF COURSE & ESTATES TRACT 4076B PARCELS Q, R, K-K & W-W
211	226-13-227B	See mailing address	UNITED STATES OF AMERICA TRUSTEE	DESERT LAKES GOLF COURSE & ESTATES TRACT 4076B PARCELS L, M, N, O & L-L
212	226-13-228A	See mailing address	UNITED STATES OF AMERICA TRUSTEE	DESERT LAKES GOLF COURSE & ESTATES TRACT 4076B PARCELS P & N-N
213	226-14-001	5947 MOUNTAIN VIEW RD	BANKSON RICHARD & GAIL	DESERT LAKES GOLF COURSE & ESTATES TRACT 4076D BLK F LOT 75 6800 SQ FT
214	226-14-002	5955 S MOUNTAIN VIEW RD	MANUEL MARIA	DESERT LAKES GOLF COURSE & ESTATES TRACT 4076D BLK F LOT 76 6000 SQ FT
215	226-14-003	5961 S MOUNTAIN VIEW RD	FIKE RICK	DESERT LAKES GOLF COURSE & ESTATES TRACT 4076D BLK F LOT 77 6000 SQ FT
216	226-14-004	5967 S MOUNTAIN VIEW RD	MC LAURINE JAMES R & SARAH E CPWRS	DESERT LAKES GOLF COURSE & ESTATES TRACT 4076D BLK F LOT 78 6000 SQ FT
217	226-14-005	5973 S MOUNTAIN VIEW RD	MC HANEY BENJAMIN JR & CONNIE J TRUSTEES	DESERT LAKES GOLF COURSE & ESTATES TRACT 4076D BLK F LOT 79 6000 SQ FT
218	226-14-006	5979 S MOUNTAIN VIEW RD	KAVA LINDA	DESERT LAKES GOLF COURSE & ESTATES TRACT 4076D BLK F LOT 80 6000 SQ FT
219	226-14-007	5985 S MOUNTAIN VIEW RD	GAUTHIER THOMAS & DIANE CPWRS	DESERT LAKES GOLF COURSE & ESTATES TRACT 4076D BLK F LOT 81 7030 SQ FT
220	226-14-008	1983 E LIPAN BLVD	WELCH CAROLA	DESERT LAKES GOLF COURSE & ESTATES TRACT 4076D BLK F LOT 82 6005 SQ FT
221	226-14-009	1977 E LIPAN BLVD	MARTINEZ MIN	DESERT LAKES GOLF COURSE & ESTATES TRACT 4076D BLK F LOT 83 6000 SQ FT
222	226-14-010	1971 E LIPAN BLVD	ABBE CHRISTOPHER & AMANDA	DESERT LAKES GOLF COURSE & ESTATES TRACT 4076D BLK F LOT 84 6000 SQ FT
223	226-14-011	1965 E LIPAN BLVD	PATCH ALAN & SHANNON	DESERT LAKES GOLF COURSE & ESTATES TRACT 4076D BLK F LOT 85 6000 SQ FT
224	226-14-012	1961 E LIPAN BLVD	MEADE LARRY & DONNA CPWRS	DESERT LAKES GOLF COURSE & ESTATES TRACT 4076D BLK F LOT 86 6403 SQ FT
225	226-14-013	See mailing address	AMERICAN GOLF CORPORATION	DESERT LAKES GOLF COURSE & ESTATES TRACT 4076D PARCEL K-K 1015 SQ FT
226	226-23-002A	5989 S LIPAN CT	ANDERSON ANDERS GUNTHER & CINDY CPWRS	DESERT LAKES GOLF COURSE & ESTATES TRACT 4163 UNIT E LOTS 1 & 2 9360 SQ FT
227	226-23-003	5993 S LIPAN CT	SHAFFER ADAM R	DESERT LAKES GOLF COURSE & ESTATES TRACT 4163 UNIT E LOT 3
228	226-23-004	5997 S LIPAN CT	FERRELL KEVIN & LISA CPWRS	DESERT LAKES GOLF COURSE & ESTATES TRACT 4163 UNIT E LOT 4
229	226-23-005	1815 E LIPAN CIR	SIMMS MICHAEL JT ETAL	DESERT LAKES GOLF COURSE & ESTATES TRACT 4163 UNIT E LOT 5
230	226-23-006	1811 E LIPAN CIR	ENRIQUEZ VICTOR M JR	DESERT LAKES GOLF COURSE & ESTATES TRACT 4163 UNIT E LOT 6
231	226-23-007	1807 E LIPAN CIR	CABRERA ARTURO	DESERT LAKES GOLF COURSE & ESTATES TRACT 4163 UNIT E LOT 7
232	226-23-009A	1803 E LIPAN CIR	KNIGHT WILLIAM R & NANCY LJT	DESERT LAKES GOLF COURSE & ESTATES TRACT 4163 UNIT E LOTS 8 & 9 CONT 10583 SQ FT

507

233	226-23-010A	1795 E LIPAN CIR	EDWARDS RICKY D JR & CHELSEE R	DESERT LAKES GOLF COURSE & ESTATES TRACT 4163 UNIT E LOT 10 & ELY 1/2 OF LOT 11 7262 SQ FT
234	226-23-012A	1787 LIPAN CIR	FLORES RUBEN A & SALVADOR-FLORES LUPE	DESERT LAKES GOLF COURSE & ESTATES TRACT 4163 UNIT E LOT 12 & THE W2 LOT 11 7234 SQ FT
235	226-23-013A	1783 E LIPAN CIR	HILLIER BARRY & JUDY	DESERT LAKES GOLF COURSE & ESTATES TRACT 4163 UNIT E LOT 13 AND E2 OF LOT 14 7219 SQ FT
236	226-23-015A	1775 E LIPAN CIR	HIRSCHER WAYNE D & DIANE E	DESERT LAKES GOLF COURSE & ESTATES TRACT 4163 UNIT E LOT 15 & WLY 1/2 LOT 14 7204 SQ FT
237	226-23-016A	1771 E LIPAN CIR	THOMAS MICHAEL J AND CHRISTINE K	DESERT LAKES GOLF COURSE & ESTATES TRACT 4163 UNIT E LOT 16 & ELY 1/2 OF LOT 17 7280 SQ FT
238	226-23-018A	1763 E LIPAN CIR	BRAMMER JACK	DESERT LAKES GOLF COURSE & ESTATES TRACT 4163 UNIT E LOT 18 & WLY 1/2 LOT 17 CONT 7802 SQ FT
239	226-23-019	1762 E LIPAN CIR	MCCLELLAND JOHN N JR & SHERRY A JT	DESERT LAKES GOLF COURSE & ESTATES TRACT 4163 UNIT E LOT 19
240	226-23-020A	1766 E LIPAN CIR	DESMIDT DANIEL A & LEE ANNE	DESERT LAKES GOLF COURSE & ESTATES TRACT 4163 UNIT E LOT 20 & WLY 1/2 LOT 21 CONT 7190 SQ FT
241	226-23-022A	1774 E LIPAN CIR	MCKEAN DONNA	DESERT LAKES GOLF COURSE & ESTATES TRACT 4163 UNIT E LOT 22 & ELY 1/2 LOT 21 7261 SQ FT
242	226-23-023A	1778 E LIPAN CIR	MONTOYA KEITH & DONNA CPWRS	DESERT LAKES GOLF COURSE & ESTATES TRACT 4163 UNIT E LOT 23 & WLY 1/2 LOT 24 7269 SQ FT
243	226-23-025A	1788 E LIPAN CIR	GARCIA ROSE	DESERT LAKES GOLF COURSE & ESTATES TRACT 4163 UNIT E LOT 25 & ELY 1/2 OF LOT 24 7191 SQ FT
244	226-23-026	1799 E LIPAN BLVD	WALLING GRANT	DESERT LAKES GOLF COURSE & ESTATES TRACT 4163 UNIT E LOT 26
245	226-23-027	1795 E LIPAN BLVD	PIERCE WENDY	DESERT LAKES GOLF COURSE & ESTATES TRACT 4163 UNIT E LOT 27
246	226-23-028	1791 E LIPAN BLVD	FUHRMEISTER GARY L & MONICA A	DESERT LAKES GOLF COURSE & ESTATES TRACT 4163 UNIT E LOT 28
	226-23-029	1787 E LIPAN BLVD	BURDEN DENNIS B & ZOSIMA CPWRS	DESERT LAKES GOLF COURSE & ESTATES TRACT 4163 UNIT E LOT 29
	226-23-030	1783 E LIPAN BLVD	TURNER SCHUYLER C	DESERT LAKES GOLF COURSE & ESTATES TRACT 4163 UNIT E LOT 30
249	226-23-031	1777 E LIPAN BLVD	JUNG DANIEL R JT 50	DESERT LAKES GOLF COURSE & ESTATES TRACT 4163 UNIT E LOT 31
250	226-23-032	1773 E LIPAN BLVD	GUTIERREZ BALDWIN & PULVERA ANASTACIO J	DESERT LAKES GOLF COURSE & ESTATES TRACT 4163 UNIT E LOT 32
251	226-20-001	5557 S WISHING WELL WAY	VIRAMONTES LEA	DESERT LAKES GOLF COURSE & ESTATES TRACT 4132 UNIT F BLK 1 LOT 1 6912 SQ FT
252	226-20-002	5549 S WISHING WELL WAY	BALDWIN WILLIAM S	DESERT LAKES GOLF COURSE & ESTATES TRACT 4132 UNIT F BLK 1 LOT 2 6000 SQ FT
253	226-20-003	5545 S WISHING WELL WAY	MOODY FRED J & KATHRYN L	DESERT LAKES GOLF COURSE & ESTATES TRACT 4132 UNIT F BLK 1 LOT 3 6000 SQ FT
254	226-20-004	5539 S WISHING WELL WAY	CAMPBELL ROSIE	DESERT LAKES GOLF COURSE & ESTATES TRACT 4132 UNIT F BLK 1 LOT 4 6000 SQ FT
255	226-20-005	5535 S WISHING WELL WAY	GARCIA ERICK M & CHEE YANELI	DESERT LAKES GOLF COURSE & ESTATES TRACT 4132 UNIT F BLK 1 LOT 5 6000 SQ FT
256	226-20-006	5529 S WISHING WELL WAY	HANMER ARTHUR & SHIRLEY JT	DESERT LAKES GOLF COURSE & ESTATES TRACT 4132 UNIT F BLK 1 LOT 6 6000 SQ FT
257	226-20-007	5525 S WISHING WELL WAY	PARKER MARLYCE E	DESERT LAKES GOLF COURSE & ESTATES TRACT 4132 UNIT F BLK 1 LOT 7 6000 SQ FT
258	226-20-008	5519 S WISHING WELL WAY	MILLER KEVIN	DESERT LAKES GOLF COURSE & ESTATES TRACT 4132 UNIT F BLK 1 LOT 8 7560 SQ FT
259	226-20-009	5515 S WISHING WELL WAY	OLIPHANT ROBERT B	DESERT LAKES GOLF COURSE & ESTATES TRACT 4132 UNIT F BLK 1 LOT 9 10446 SQ FT
260	226-20-010	1837 E CLUB HOUSE WAY	AGUILAR BREANNA	DESERT LAKES GOLF COURSE & ESTATES TRACT 4132 UNIT F BLK 1 LOT 10 7840 SQ FT
261	226-20-011	1843 E CLUBHOUSE WAY	BENAVIDEZ CHARLES & BRIDGIT CPWRS	DESERT LAKES GOLF COURSE & ESTATES TRACT 4132 UNIT F BLK 1 LOT 11 7494 SQ FT
262	226-20-012	1847 E CLUBHOUSE WAY	BRIC INVESTMENTS INC	DESERT LAKES GOLF COURSE & ESTATES TRACT 4132 UNIT F BLK 1 LOT 12 7200 SQ FT
263	226-20-013	1853 E CLUB HOUSE WAY	BURNS JULIA	DESERT LAKES GOLF COURSE & ESTATES TRACT 4132 UNIT F BLK 1 LOT 13 7200 SQ FT
	226-20-014	1859 E CLUBHOUSE WAY	MCLERRAN LARRY & KAREN	DESERT LAKES GOLF COURSE & ESTATES TRACT 4132 UNIT F BLK 1 LOT 14 7200 SQ FT
	226-20-015	1863 E CLUB HOUSE WAY	OLIVER MICHAEL & CHERYL TRS	DESERT LAKES GOLF COURSE & ESTATES TRACT 4132 UNIT F BLK 1 LOT 15 7200 SQ FT
266	226-20-016	1869 E CLUB HOUSE WAY	SPELTZ ANTHONY W	DESERT LAKES GOLF COURSE & ESTATES TRACT 4132 UNIT F BLK 1 LOT 16 7200 SQ FT
267	226-20-017	1873 E CLUB HOUSE WAY	PIONEER TITLE TR 9051	DESERT LAKES GOLF COURSE & ESTATES TRACT 4132 UNIT F BLK 1 LOT 17 8114 SQ FT
268	226-20-018	5558 S WISHING WELL WAY	PIONEER TITLE TR 9051	DESERT LAKES GOLF COURSE & ESTATES TRACT 4132 UNIT F BLK 2 LOT 1 7992 SQ FT
269	226-20-019	5550 S WISHING WELL WAY	SANCHEZ RAFAEL SERRANO	DESERT LAKES GOLF COURSE & ESTATES TRACT 4132 UNIT F BLK 2 LOT 2 6600 SQ FT
270	226-20-020	5546 S WISHING WELL WAY	BURGESS RODNEY C JR	DESERT LAKES GOLF COURSE & ESTATES TRACT 4132 UNIT F BLK 2 LOT 3 6600 SQ FT
271	226-20-021	5538 S WISHING WELL WAY	WHEATON SCOTT D & CAROL	DESERT LAKES GOLF COURSE & ESTATES TRACT 4132 UNIT F BLK 2 LOT 4 6600 SQ FT
272	226-20-022	5532 S WISHING WELL WAY	CALVILLO ALEJANDRO & AIDE	DESERT LAKES GOLF COURSE & ESTATES TRACT 4132 UNIT F BLK 2 LOT 5 7225 SQ FT
273	226-20-023	1840 E CLUB HOUSE WAY	PIONEER TITLE TR 9051	DESERT LAKES GOLF COURSE & ESTATES TRACT 4132 UNIT F BLK 2 LOT 6 7602 SQ FT
274	226-20-024	1846 E CLUB HOUSE WAY	SINGER DONALD E & DIANE L CPWRS	DESERT LAKES GOLF COURSE & ESTATES TRACT 4132 UNIT F BLK 2 LOT 7 7144 SQ FT
275	226-20-025	1852 E CLUB HOUSE WAY	PIONEER TITLE TR 9051	DESERT LAKES GOLF COURSE & ESTATES TRACT 4132 UNIT F BLK 2 LOT 8 9879 SQ FT
276	226-20-026	5525 S CLUB HOUSE CT	PIONEER TITLE TR 9051	DESERT LAKES GOLF COURSE & ESTATES TRACT 4132 UNIT F BLK 2 LOT 9 7005 SQ FT
277	226-20-027	5531 S CLUB HOUSE CT	THOMPSON LOWELL W JR & JUDITH A	DESERT LAKES GOLF COURSE & ESTATES TRACT 4132 UNIT F BLK 2 LOT 10 6971 SQ FT
278	226-20-028	5537 S CLUB HOUSE CT	PIONEER TITLE TR 9051	DESERT LAKES GOLF COURSE & ESTATES TRACT 4132 UNIT F BLK 2 LOT 11 7309 SQ FT
279	226-20-029	5543 S CLUB HOUSE CT	WEE JHYSHAIN	DESERT LAKES GOLF COURSE & ESTATES TRACT 4132 UNIT F BLK 2 LOT 12 10642 SQ FT

687



280	226-20-030	5547 S CLUB HOUSE CT	EPLER GARTH E & CHERYL L CPWRS	DESERT LAKES GOLF COURSE & ESTATES TRACT 4132 UNIT F BLK 2 LOT 13	11290 SQ FT
281	226-20-031	1851 E WISHING WELL LN	PIONEER TITLE TR 9051	DESERT LAKES GOLF COURSE & ESTATES TRACT 4132 UNIT F BLK 2 LOT 14	13660 SQ FT
282	226-20-032	5548 S CLUB HOUSE CT	CORDARO MICHAEL A	DESERT LAKES GOLF COURSE & ESTATES TRACT 4132 UNIT F BLK 2 LOT 15	11065 SQ FT
283	226-20-033	5544 S CLUB HOUSE CT	CARLSON LARRY E & ANNA	DESERT LAKES GOLF COURSE & ESTATES TRACT 4132 UNIT F BLK 2 LOT 16	9203 SQ FT
284	226-20-034	5540 S CLUB HOUSE CT	GOODWIN PAUL L & DARLENE FAY TRUSTEES	DESERT LAKES GOLF COURSE & ESTATES TRACT 4132 UNIT F BLK 2 LOT 17	8749 SQ FT
285	226-20-035	5536 S CLUB HOUSE CT	JUAREZ MAURICE & JERILYN CPWRS	DESERT LAKES GOLF COURSE & ESTATES TRACT 4132 UNIT F BLK 2 LOT 18	8496 SQ FT
286	226-20-036	5532 S CLUB HOUSE CT	JURSKI FORTUNE JARED & FORTUNE RILEY	DESERT LAKES GOLF COURSE & ESTATES TRACT 4132 UNIT F BLK 2 LOT 19	6910 SQ FT
287	226-20-037	5528 S CLUB HOUSE CT	PIONEER TITLE TR 9051	DESERT LAKES GOLF COURSE & ESTATES TRACT 4132 UNIT F BLK 2 LOT 20	6542 SQ FT
288	226-20-038	5524 S CLUB HOUSE CT	PIONEER TITLE TR 9051	DESERT LAKES GOLF COURSE & ESTATES TRACT 4132 UNIT F BLK 2 LOT 21	7176 SQ FT
289	226-20-039	See Mailing Address CA	DESERT LAKES AND GOLF COURSE LLC	DESERT LAKES GOLF COURSE & ESTATES TRACT 4132 UNIT F BLK 2 PARCEL A	3575 SQ FT
290	226-20-040	See Mailing Address NY	DESERT LAKES & GOLF COURSE	DESERT LAKES GOLF COURSE & ESTATES TRACT 4132 UNIT F BLK 1 PARCEL B	1349 SQ FT

Phase III on Preliminary Plat (aka Tract 4132) was combined with Phase II (said tract 4076-B) See Book 1641, p 897  
Block F (12 lots) aka Tract "D" are a part of Phase II (said tract 4076-B) built according to Tract B CC&Rs with Frontage Rd.  
Parcel VV aka Tract 4163 Unit E is a part of Phase II (said tract 4076-B) CC&Rs run with the land for Parcel VV  
Tract 4132 spelled out the four lots with a DE that was not to be blocked para 15 (Book 3008, Pg 678)

1  
2  
3  
4  
5  
6  
7  
8  
9  
10  
11  
12  
13  
14  
15  
16  
17  
18  
19  
20  
21  
22  
23  
24  
25  
26  
27  
28

COPY of the foregoing emailed on this 1st day of June, 2020 to:

djlaw@frontiernet.net

Attorney for Defendants

Daniel J. Oehler, Esq.  
Law Offices of Daniel J. Oehler  
2001 Highway 95, Suite 15  
Bullhead City, Arizona 86442